

各対象施設の工事期間中の運営範囲及び工事対象範囲

1. 勤労会館 ホワイエ天井(耐震化天井工事)、ホール天井(落下防止措置)
1.1. 配置図

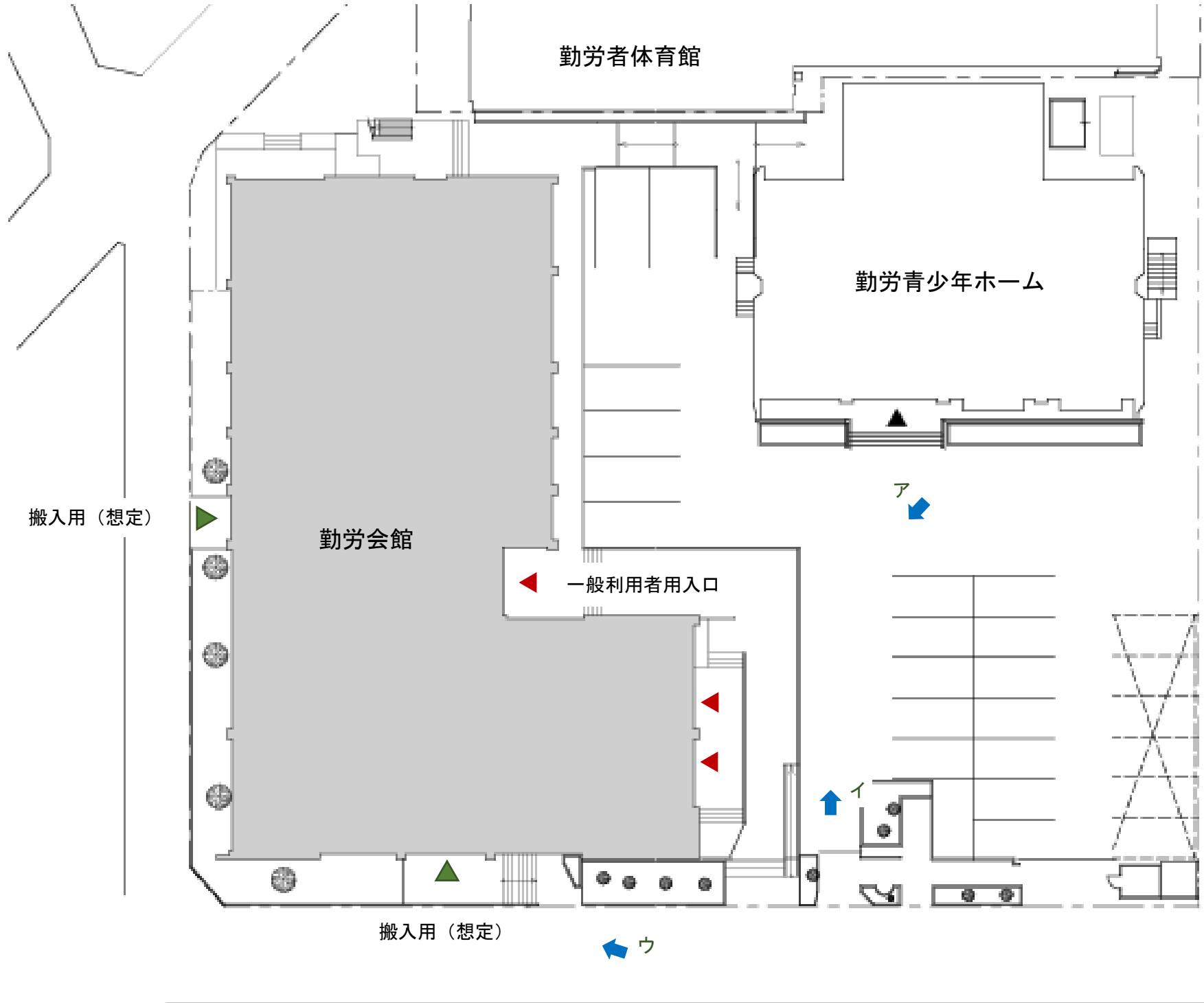

1.2. 1階平面図

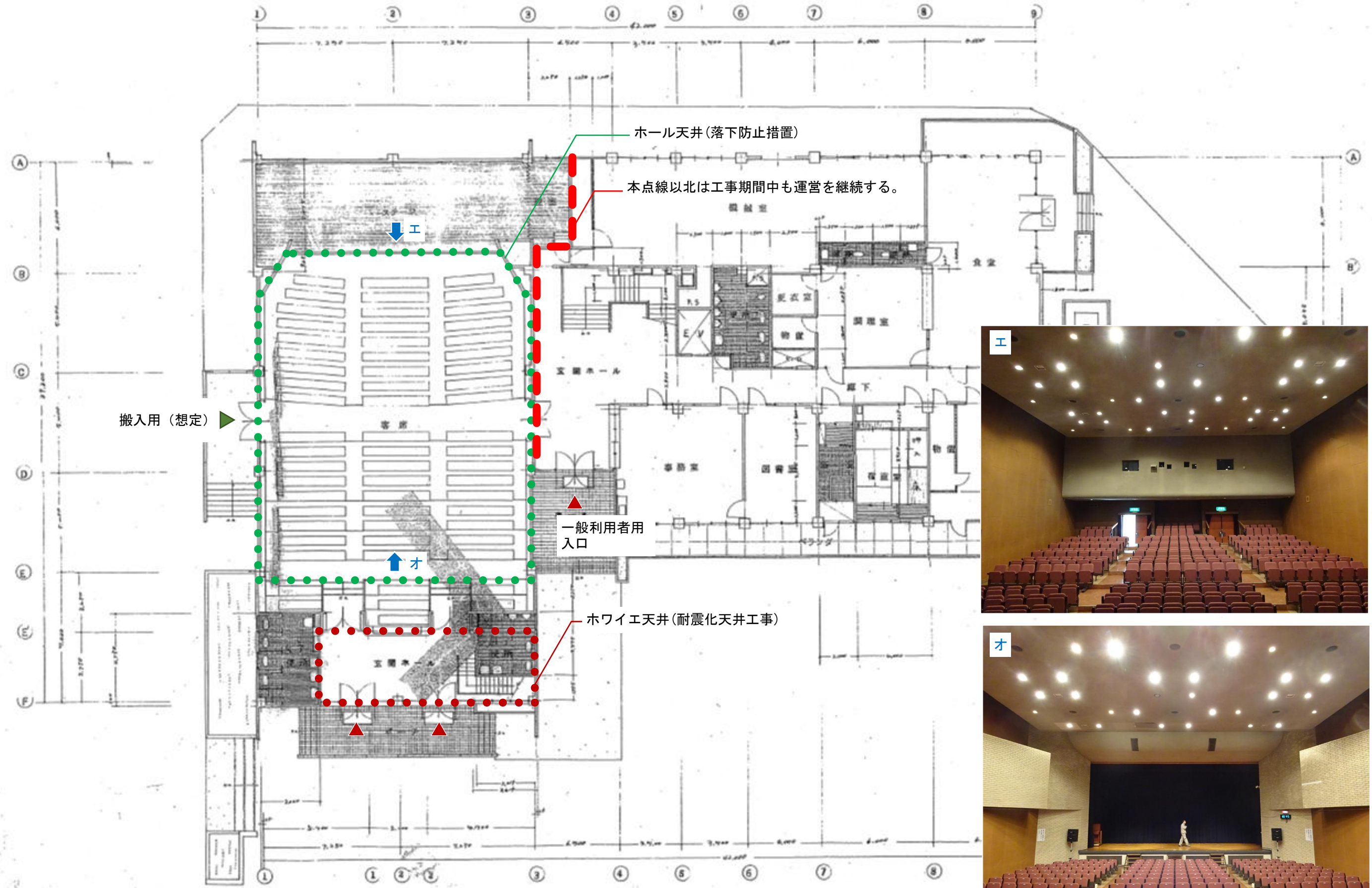

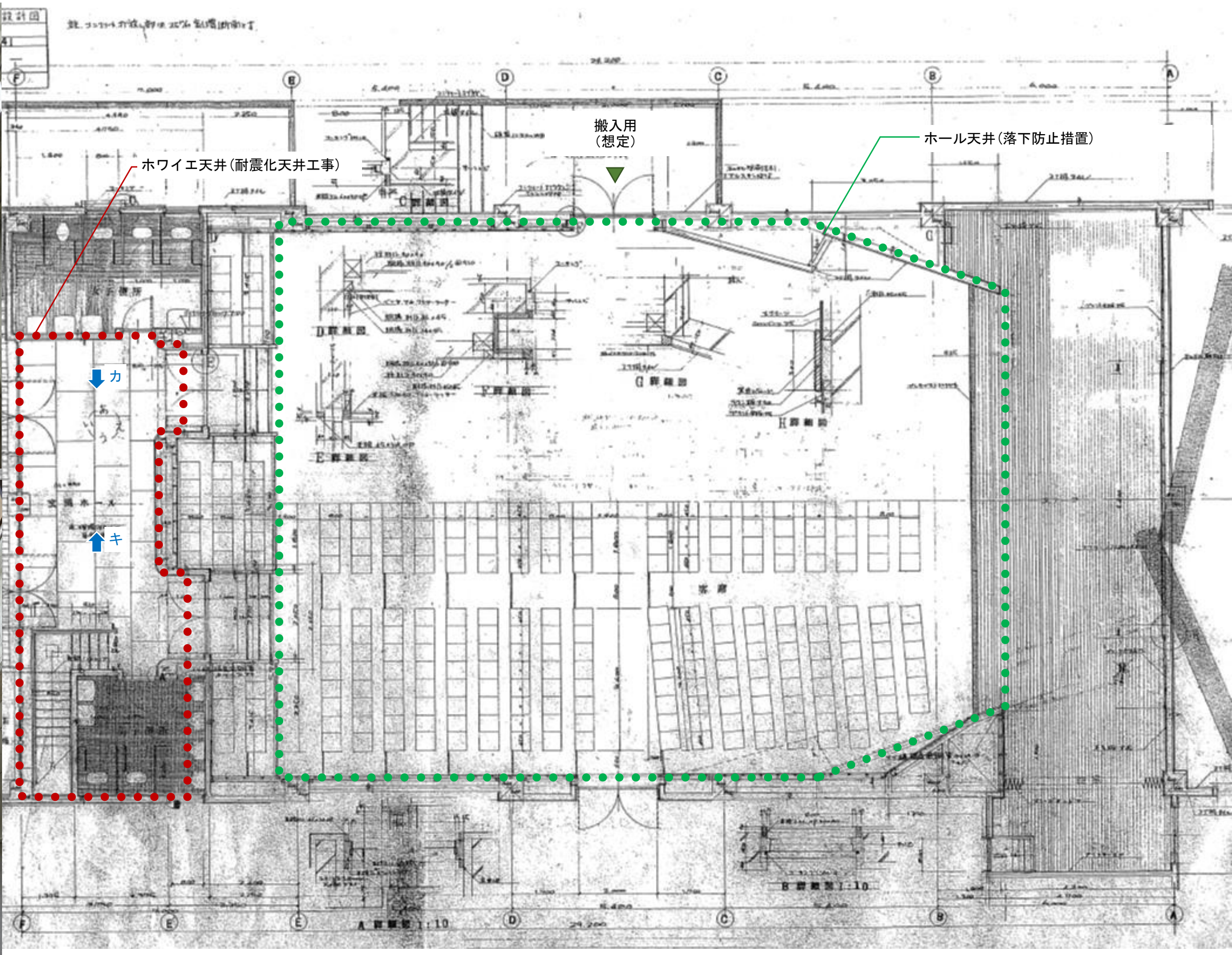

1.3. 断面図

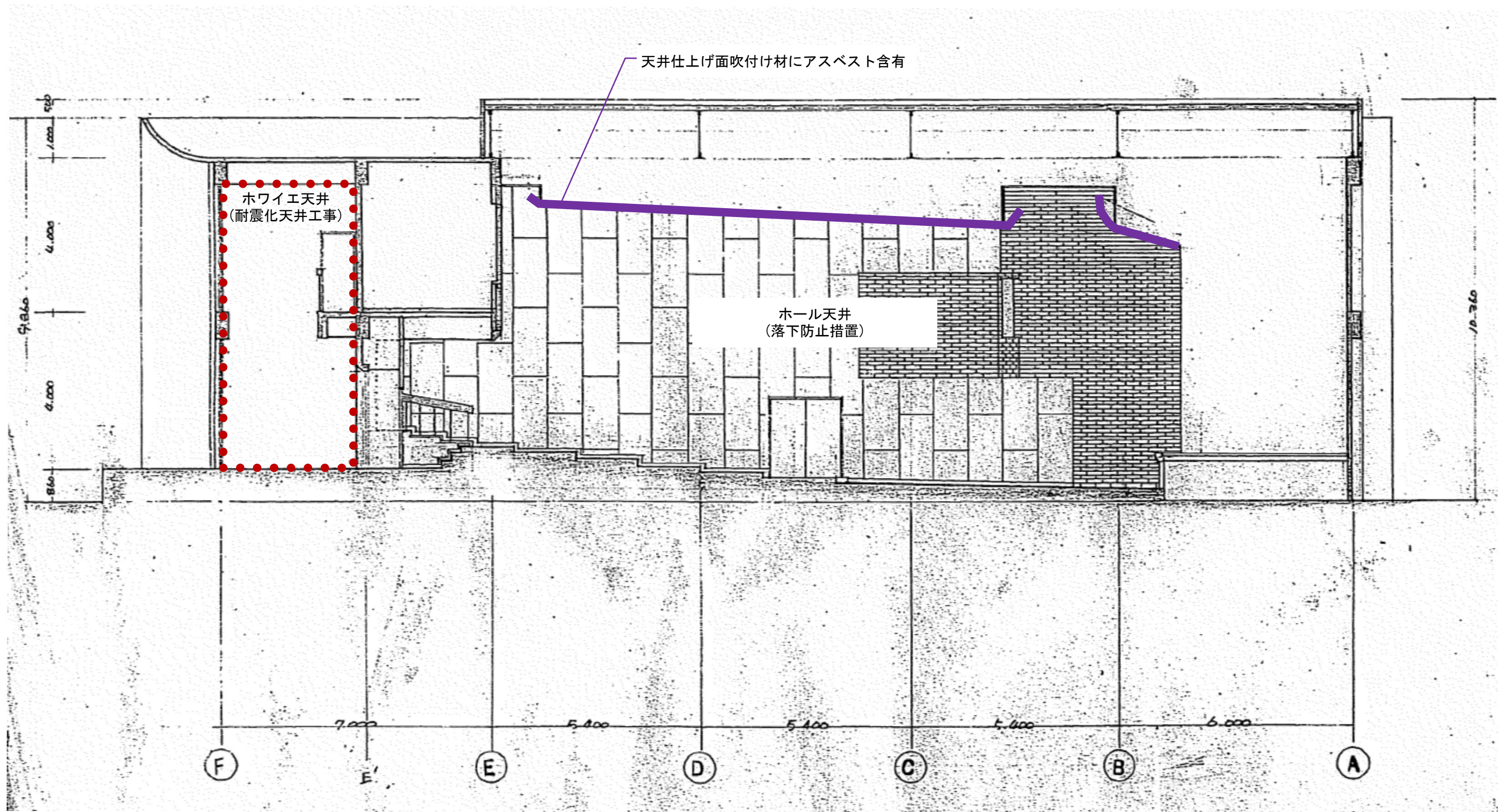

2. 西宮東高校ホール(落下防止措置)

2.1. 配置図

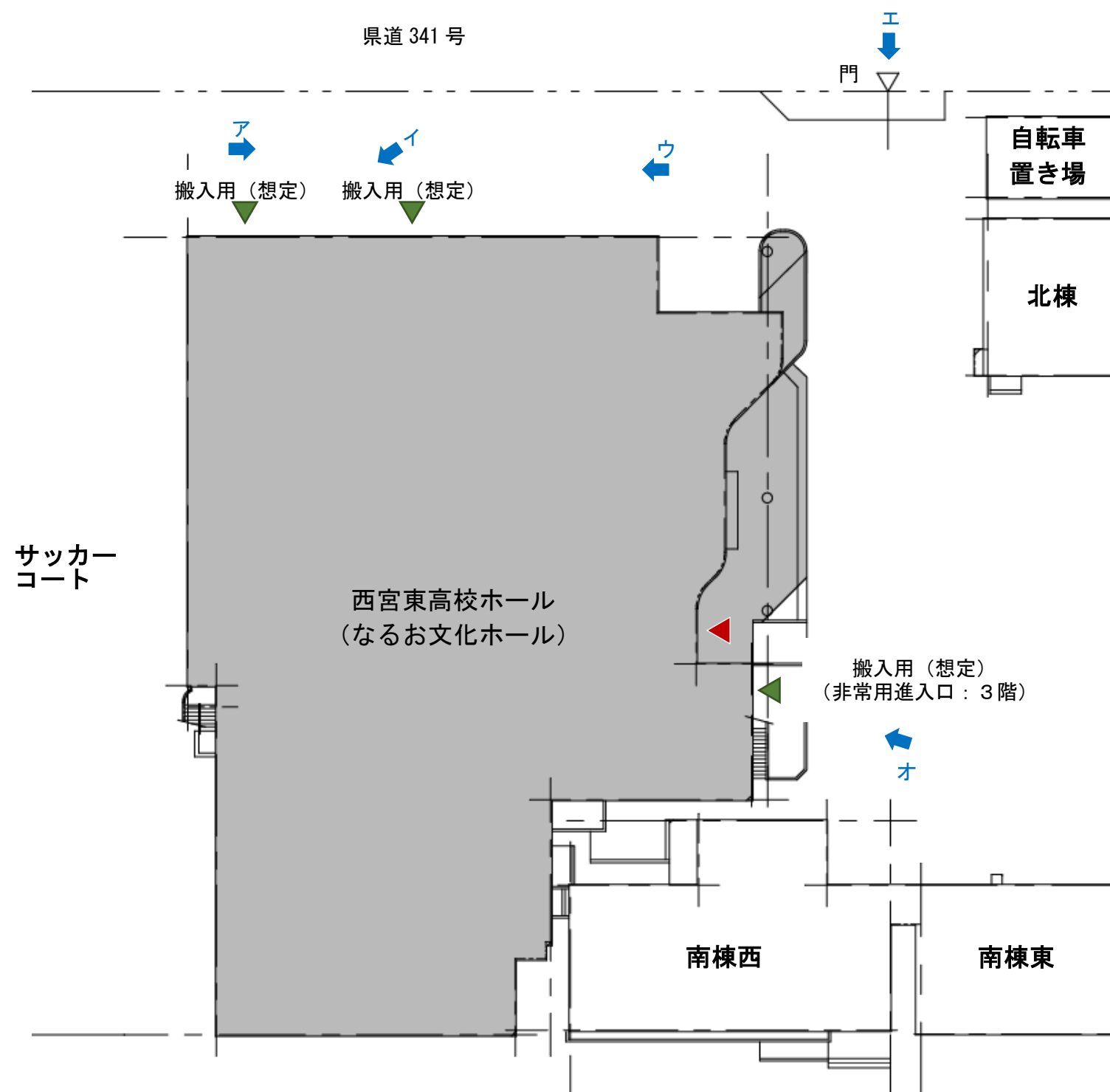

2.2. 1階平面図

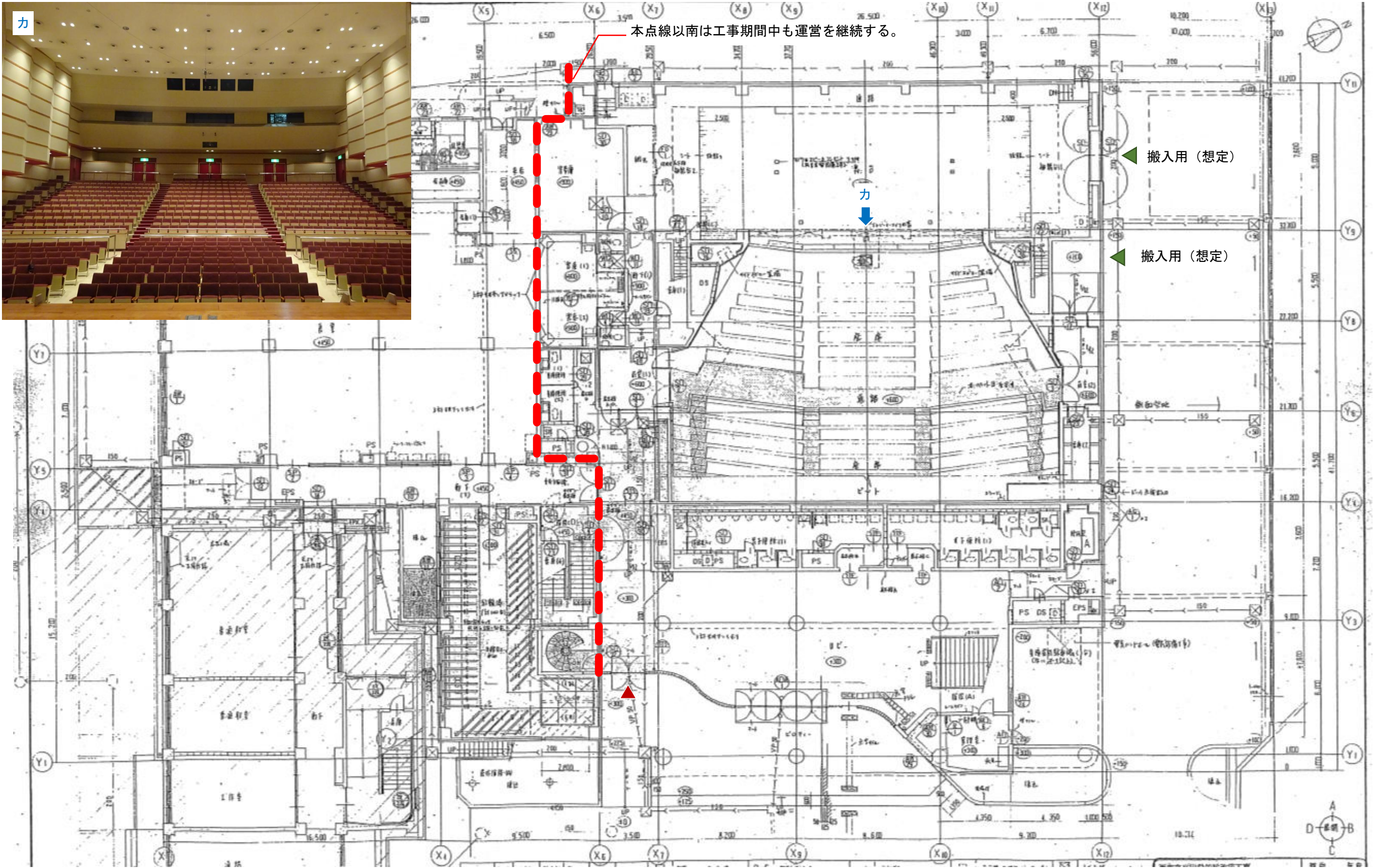

2.3. 2階平面図

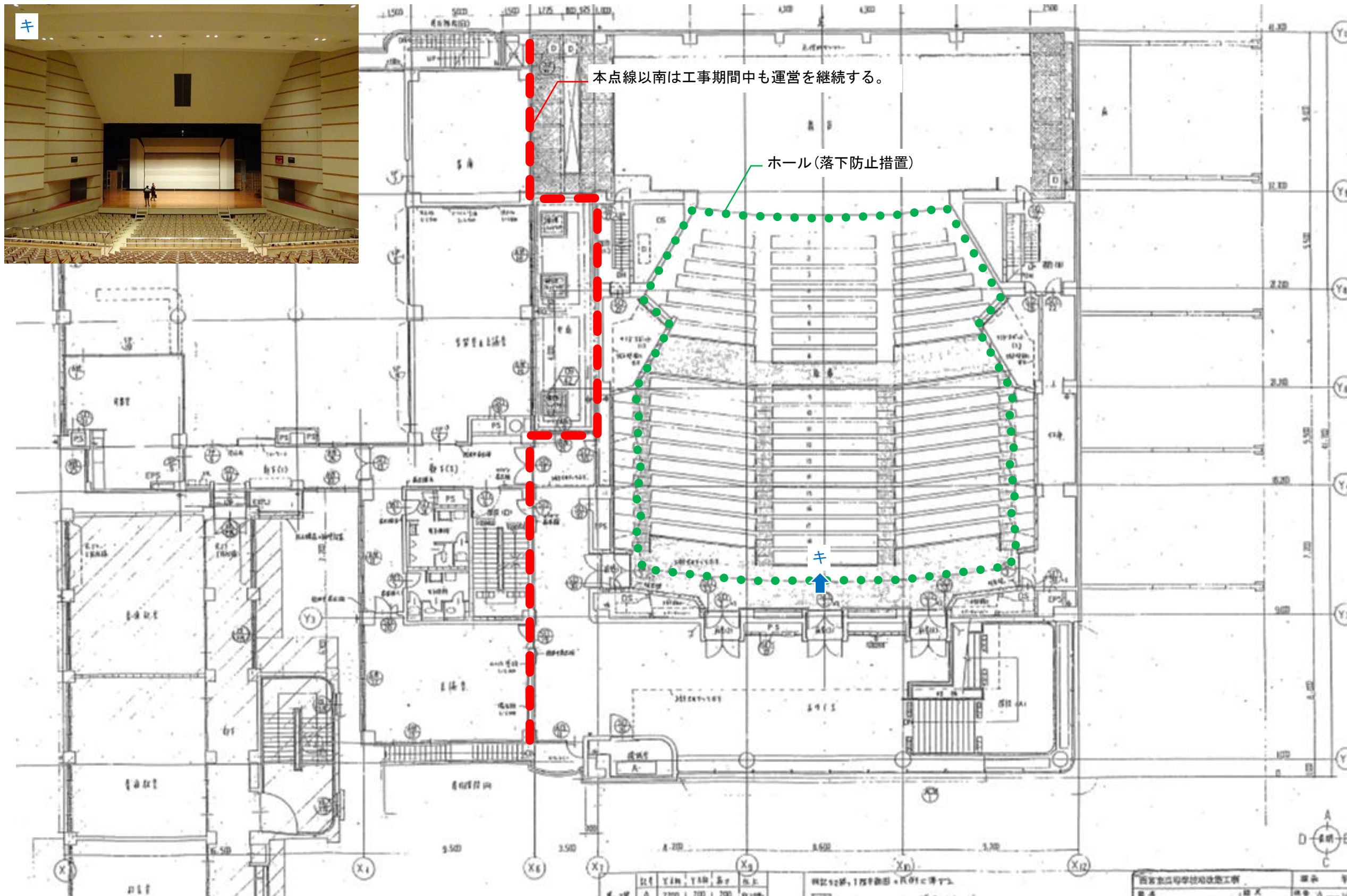

2.4. 断面図

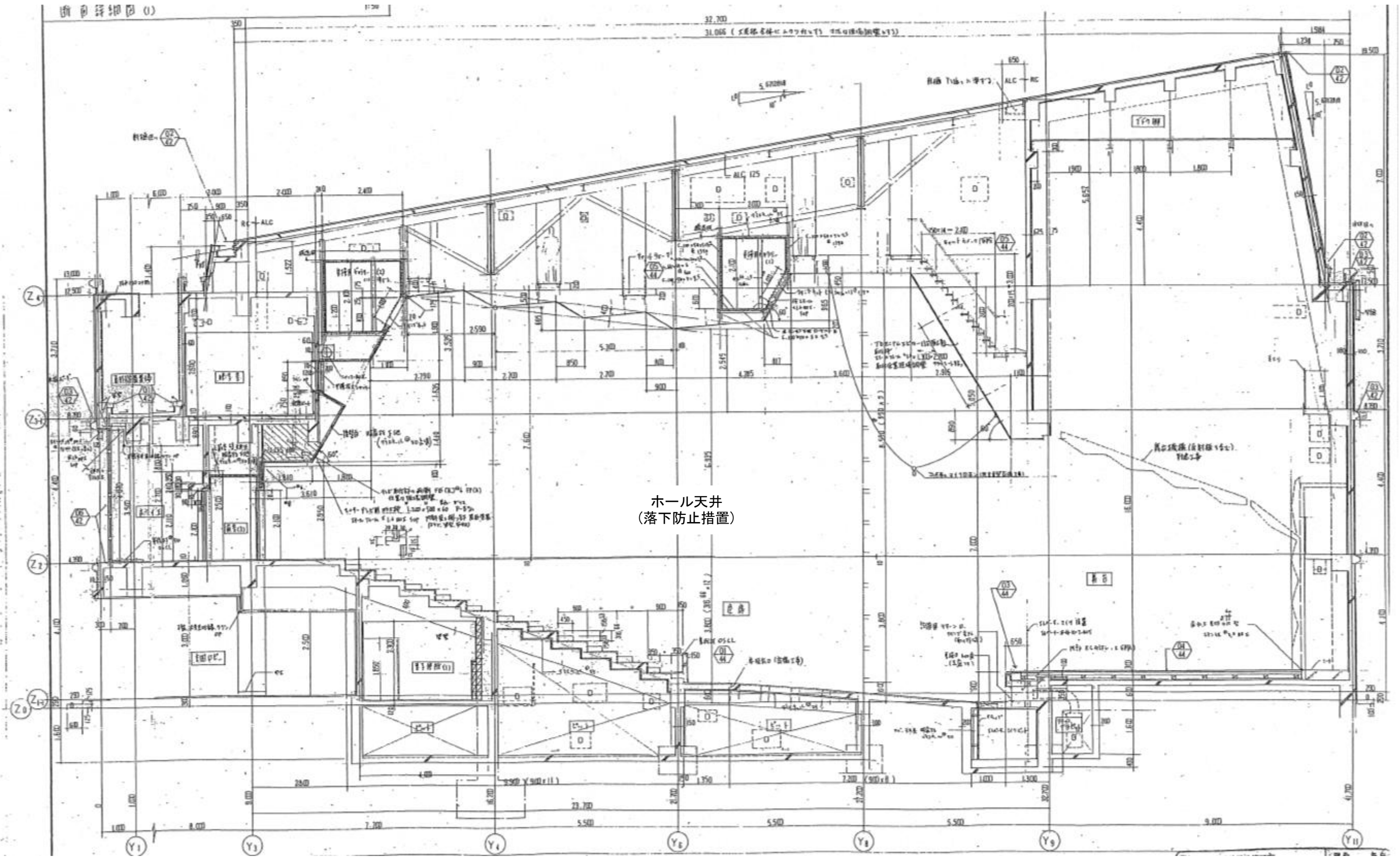

3. 西宮市民会館 ホワイエ天井、ホール天井(落下防止措置)

3.1. 配置図

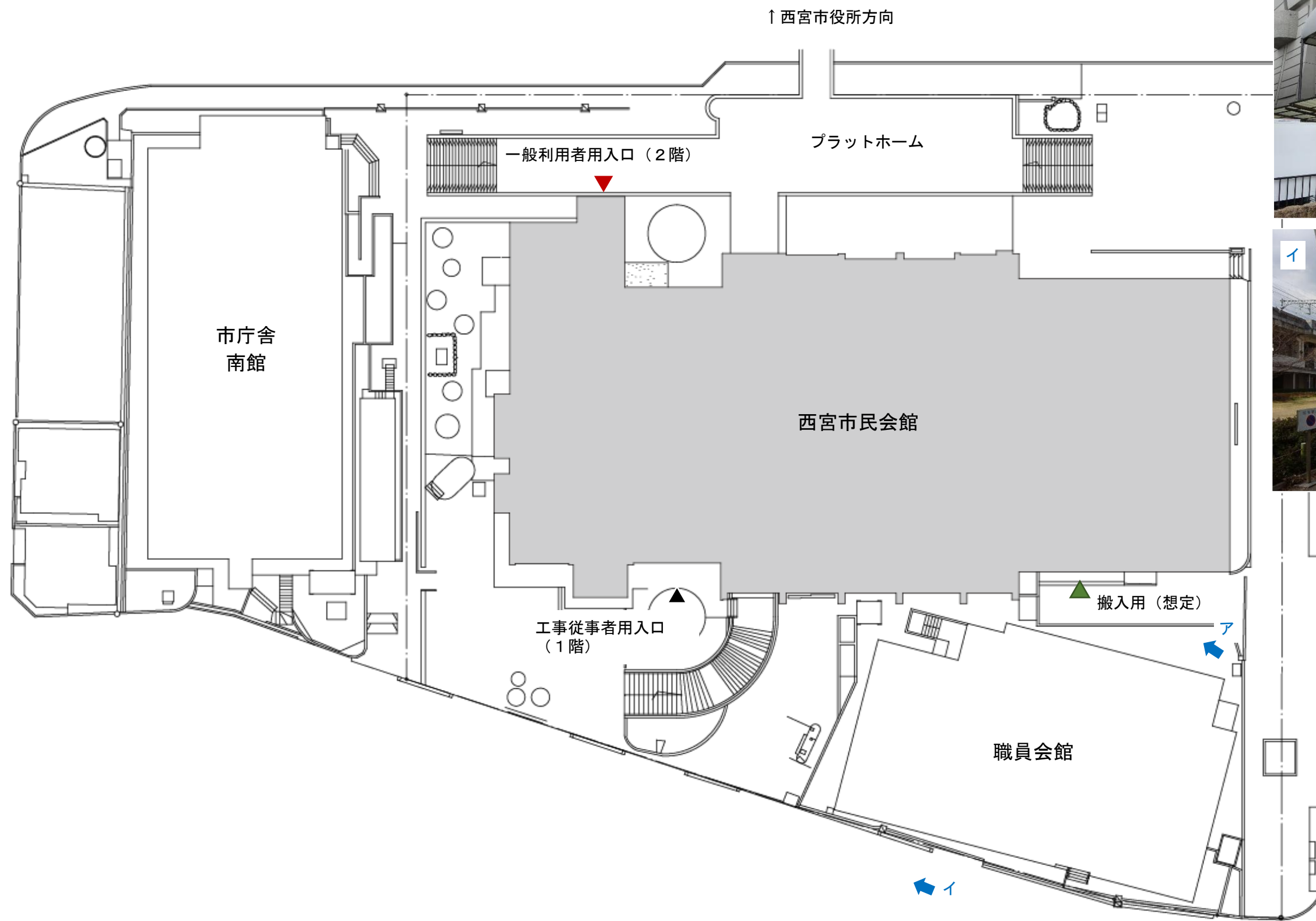

3.2. 2階平面図

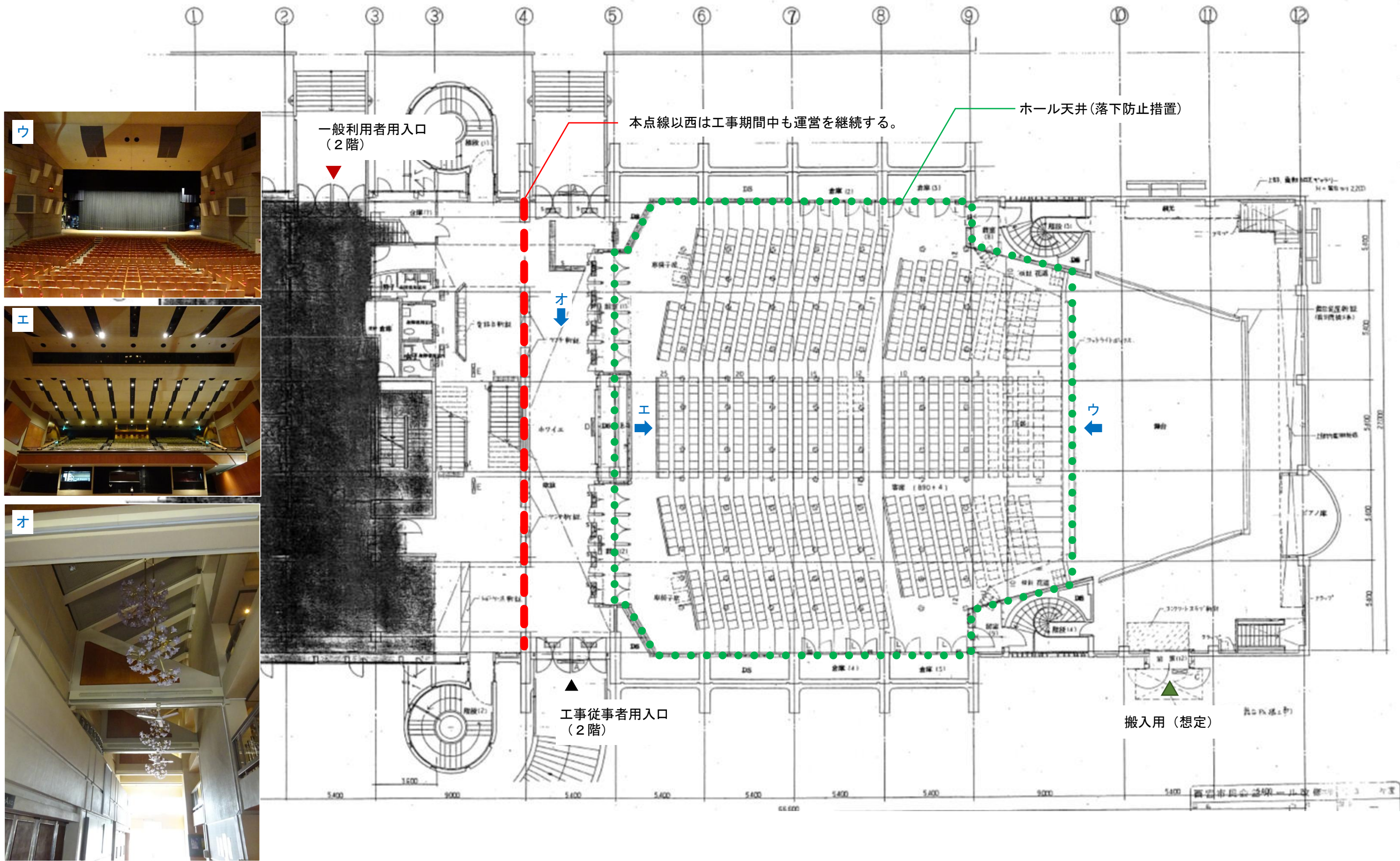

3.4. 断面図

